



# Westfield Energy Recovery (WER)

Kinglassie, Edimburg, Scotland /

Structural type  
Characteristics  
Owner  
Client  
Scope

Energy  
incineration plant for electricity production  
Westfield Energy Recovery  
Hitachi Zosen Inova AG (HZI)  
Detailed Design of the structures (EOR)

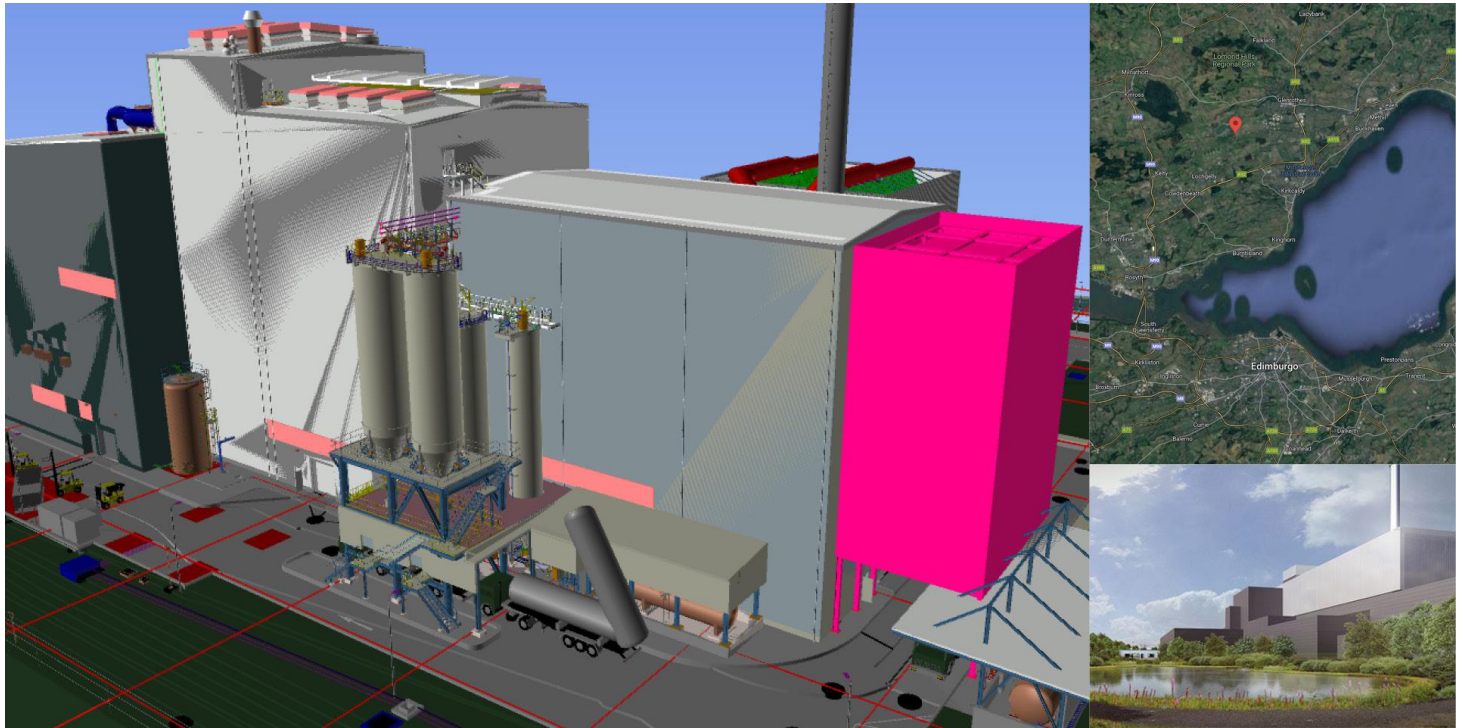

Structural engineering project of steel structures of a new energy recovery from waste plant owned by Westfield Energy Recovery Limited.

Westfield Energy Recovery will build a waste incineration plant with energy recovery in Kinglassie, north of Edimburgh (UK). The plant is expected to produce 240,000 tonnes of energy per year. Hitachi Zosen Inova has been contracted to design and build the plant. FHECOR will carry out the construction design, including workshop documentation, of the steel structures for the following buildings included in the project:

- § Combustion and Boiler Area (CB)
- § Flue Gas Treatment Area (FGT)
- § Water Steam Cycle Area (WSC)
- § Balance of Plants Area (BOP)
- § Electrical Instrument and Consumer area (EIC)



C/ Barquillo 23, 2º | 28004 Madrid | España  
T. (+34) 917 014 460 | F. (+34) 915 327 864  
[www.fhecor.com](http://www.fhecor.com) | [fhecor@fhecor.es](mailto:fhecor@fhecor.es)